

SMA Snap-on plug (male) / SMA jack (female) straight adaptor, DC–18 GHz, VSWR ≤ 1.15

Precision RF adaptor for fast snap-lock mating on one side and standard SMA screw-lock on the other side.

FREQUENCY

DC–18 GHz

VSWR

≤ 1.15 (≥ 23 dB)

IMPEDANCE

50 Ω

INTERFACE

SMA Snap-lock / SMA Screw-lock

HIGHLIGHTS

- SMA Snap-on plug (male) to SMA jack (female)
- DC to 18 GHz performance, VSWR ≤ 1.15
- Low insertion loss: $\leq 0.05 \times \sqrt{F(\text{GHz})}$ dB
- Snap-lock / screw-lock coupling mechanisms

APPLICATIONS

- RF test benches and calibration labs
- ATE environments requiring fast connect/disconnect
- Adapter use between snap-on and threaded SMA interfaces
- Production test and service setups



Image for reference only. Final appearance depends on configuration.

Follow standard RF handling practice. Keep mating faces clean and protected.

Reference specifications are based on the original manufacturer datasheet.

Technical Specifications

Reference Specs

Parameter	Value	Unit	Notes
Impedance	50	Ω	Characteristic impedance
Frequency	DC to 18	GHz	Operating frequency range
VSWR (Return Loss)	≤ 1.15	–	(≥ 23 dB)
Insertion loss	≤ 0.05 × √F	dB	F in GHz
Insulation resistance	≥ 5	GΩ	Reference
Center contact resistance	≤ 3	mΩ	Reference
Outer contact resistance	≤ 3	mΩ	Reference
Test voltage	1000	V rms	Dielectric withstand
Working voltage	350	V rms	Maximum continuous
Temperature range	-65 to +165	°C	Environmental
Mating cycles	≥ 500	–	Snap-lock and screw-lock
Center contact captivation	≥ 27	N	Reference
Packing	Single or 100	–	Unit packaging

Materials & Plating

Construction details

Part	Material	Plating / Finish
Centre contact (SMA)	Beryllium Copper	Gold plating, 3 μinch (non-magnetic nickel-phosphorus underplating, 80 μinch)
Body (SMA)	Brass	Gold plating, 3 μinch (non-magnetic nickel-phosphorus underplating, 80 μinch)
Insulator (SMA)	PTFE	–
Centre contact (SMA Snap-On)	Beryllium Copper	Gold plating, 3 μinch (non-magnetic nickel-phosphorus underplating, 80 μinch)
Body (SMA Snap-On)	Beryllium Copper	Gold plating, 3 μinch (non-magnetic nickel-phosphorus underplating, 80 μinch)
Insulator (SMA Snap-On)	PTFE	–
Gasket	Silicone Rubber	–
Coupling nut	Brass	Gold plating, 3 μinch (non-magnetic nickel-phosphorus underplating, 80 μinch)

Mechanical

Outline drawing

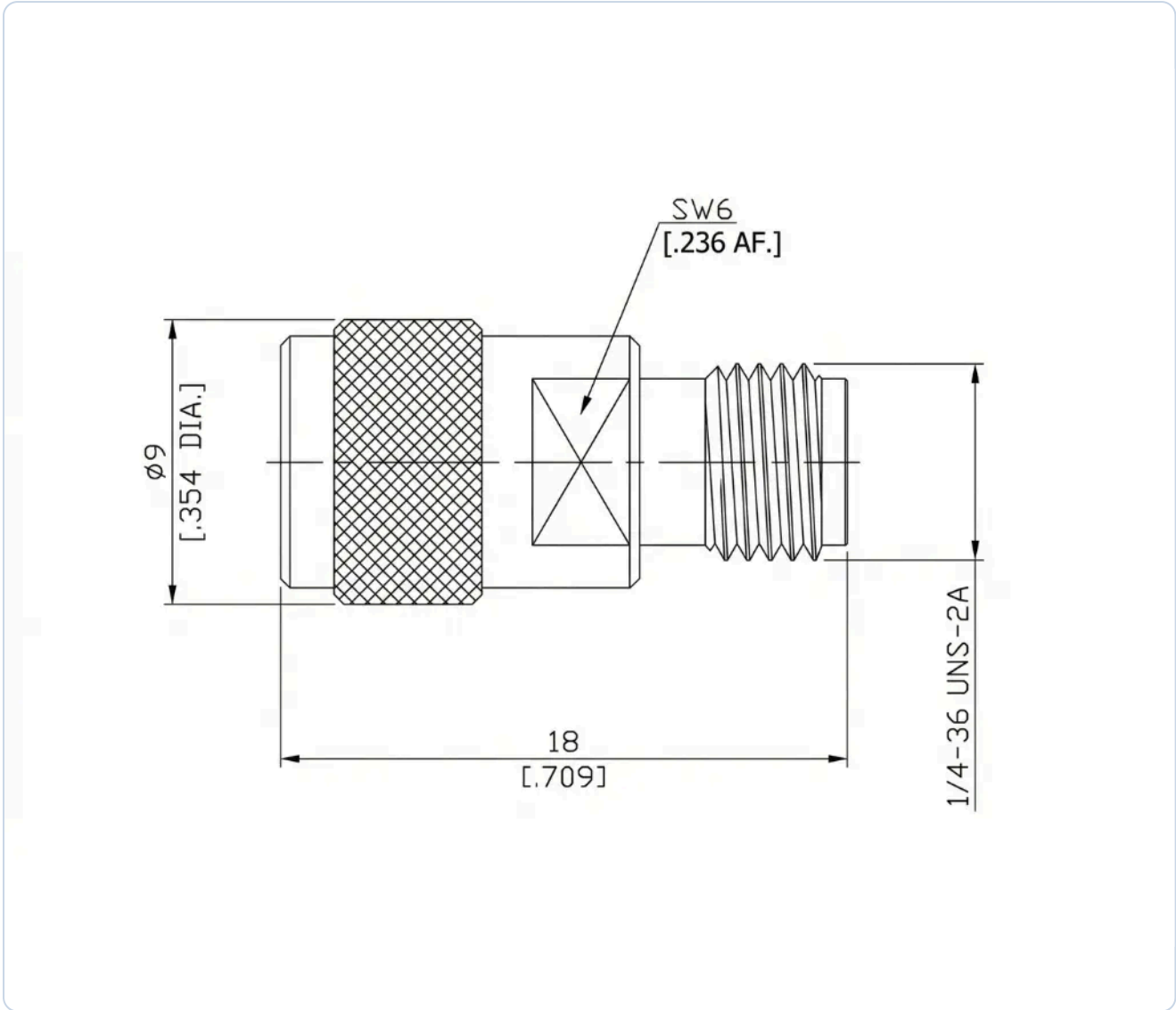

All dimensions are in mm [inch]. Tolerances according to DIN ISO 2768-mH.